



Photo Science, Inc.

CONTROL REFERENCE SUMMARY

Project Name: Woodford County GIS		Agency: VMWC Planning	
Quad Sheet: Salvisa	County: Woodford	State: KY	Date Set: 10/1/2004
Station: 126	Type of Mark: Concrete Monument	Stamping on Mark: 126	Established By: Photo Science, Inc.
Elev (USFeet) 767.60	Elev (M): 233.965	Datum: NAVD88	
Northing (USFeet) 178,421.24	Easting (USFeet) 1,478,606.19	Datum: KY North	
Northing (M) 54,382.903	Easting (M) 450,680.068	Datum: KY North	
Latitude: 37°59'18.94943"N	Longitude: 84°48'41.18835"W	Datum: NAD83	
Ahead Station:	Ahead Azimuth: ° ' "	Ahead Distance:	
Back Station: 126 AZ	Back Azimuth: 217 ° 49 ' 33 "	Back Distance: 588.00	
Data Entry: GB	Checked By: MEM	Date: 11/30/2004	

- A: 52.9' TO A 10" LOCUST TREE
- B: 36.0' TO R/W FENCE PULL POST
- C: 1.8' TO A CARSONITE POST

Point #126

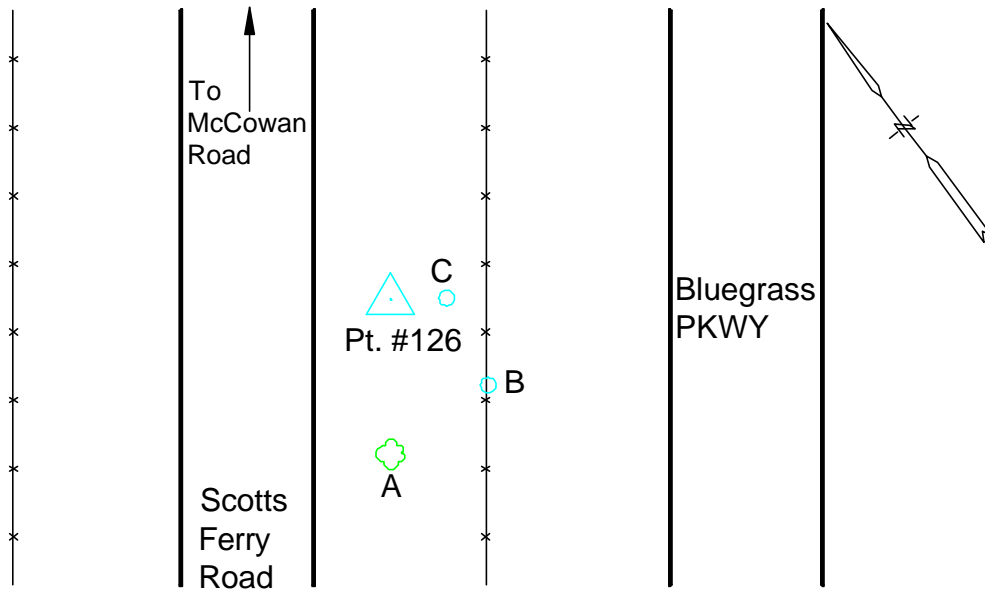



Photo Science, Inc.

CONTROL REFERENCE SUMMARY

Project Name: Woodford County GIS		Agency: VMWC Planning	
Quad Sheet: Salvisa	County: Woodford	State: KY	Date Set: 10/1/2004
Station: 126 AZ	Type of Mark: Concrete Monument	Stamping on Mark: 126 AZ	Established By: Photo Science, Inc.
Elev (USFeet) 752.42	Elev (M): 229.338	Datum: NAVD88	
Northing (USFeet) 177,956.79	Easting (USFeet) 1,478,245.59	Datum: KY North	
Northing (M) 54,241.338	Easting (M) 450,570.157	Datum: KY North	
Latitude: 37°59'14.33636"N	Longitude: 84°48'45.65705"W	Datum: NAD83	
Ahead Station: 126	Ahead Azimuth: 37° 49' 33 "	Ahead Distance: 588	
Back Station:	Back Azimuth: ° ' "	Back Distance:	
Data Entry: GB	Checked By: MEM	Date: 11/30/2004	

- A: 2.9' TO END OF GUARDRAIL
- B: 30.8' TO END OF GUARDRAIL
- C: 2.0' TO CARSONITE POST

Point #126 AZ

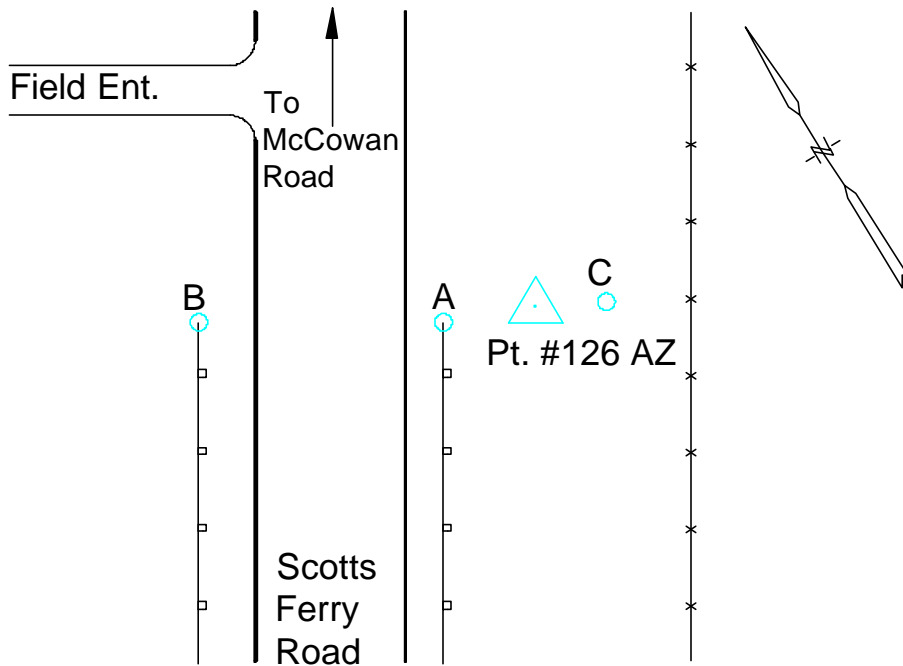



Photo Science, Inc.

CONTROL REFERENCE SUMMARY

Project Name: Woodford County GIS		Agency: VMWC Planning	
Quad Sheet: Salvisa	County: Woodford	State: KY	Date Set: 10/1/2004
Station: 127	Type of Mark: Concrete Monument	Stamping on Mark: 127	Established By: Photo Science, Inc.
Elev (USFeet) 800.03	Elev (M): 243.850	Datum: NAVD88	
Northing (USFeet) 172,831.41	Easting (USFeet) 1,481,148.09	Datum: KY North	
Northing (M) 52,679.119	Easting (M) 451,454.841	Datum: KY North	
Latitude: 37°58'23.84254"N	Longitude: 84°48'09.01914"W	Datum: NAD83	
Ahead Station:	Ahead Azimuth: ° ' "	Ahead Distance:	
Back Station: 127 AZ	Back Azimuth: 101 ° 46 ' 28 "	Back Distance: 542.43	
Data Entry: GB	Checked By: MEM	Date: 11/30/2004	

- A: 70.0' TO A TELEPHONE POLE
- B: 23.9' TO A TELEPHONE POLE
- C: 1.0' TO A CARSONITE POST

Point #127





Photo Science, Inc.

CONTROL REFERENCE SUMMARY

Project Name: Woodford County GIS		Agency: VMWC Planning	
Quad Sheet: Salvisa	County: Woodford	State: KY	Date Set: 10/1/2004
Station: 127 AZ	Type of Mark: Concrete Monument	Stamping on Mark: 127 AZ	Established By: Photo Science, Inc.
Elev (USFeet) 810.19	Elev (M): 246.946	Datum: NAVD88	
Northing (USFeet) 172,720.72	Easting (USFeet) 1,481,679.11	Datum: KY North	
Northing (M) 52,645.381	Easting (M) 451,616.696	Datum: KY North	
Latitude: 37°58'22.77976"N	Longitude: 84°48'02.37944"W	Datum: NAD83	
Ahead Station: 127	Ahead Azimuth: 281 ° 46' 28 "	Ahead Distance: 542.43	
Back Station:	Back Azimuth: ° ' "	Back Distance:	
Data Entry: GB	Checked By: MEM	Date: 11/30/2004	

- A: 75.6' TO A TELEPHONE POLE
- B: 108.2' TO A TELEPHONE POLE
- C: 19.3' TO A 14" ASH TREE

Point #127 AZ

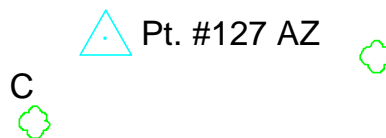
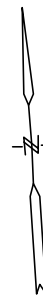
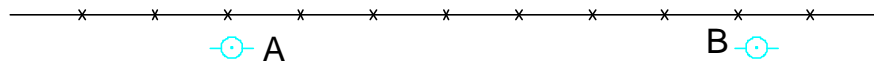



Photo Science, Inc.

CONTROL REFERENCE SUMMARY

Project Name: Woodford County GIS		Agency: VMWC Planning	
Quad Sheet: Salvisa	County: Woodford	State: KY	Date Set: 10/1/2004
Station: 128	Type of Mark: Concrete Monument	Stamping on Mark: 128	Established By: Photo Science, Inc.
Elev (USFeet) 830.72	Elev (M): 253.204	Datum: NAVD88	
Northing (USFeet) 172,374.68	Easting (USFeet) 1,489,345.45	Datum: KY North	
Northing (M) 52,539.908	Easting (M) 453,953.401	Datum: KY North	
Latitude: 37°58'19.80108"N	Longitude: 84°46'26.61658"W	Datum: NAD83	
Ahead Station:	Ahead Azimuth: ° ' "	Ahead Distance:	
Back Station: 128 AZ	Back Azimuth: 28 ° 06 ' 38 "	Back Distance: 495.15	
Data Entry: GB	Checked By: MEM	Date: 11/30/2004	

- A: 22.0' TO GATE POST
- B: 10.1' TO A TELEPHONE POST
- C: 1.4' TO A CARSONITE POST

Point #128

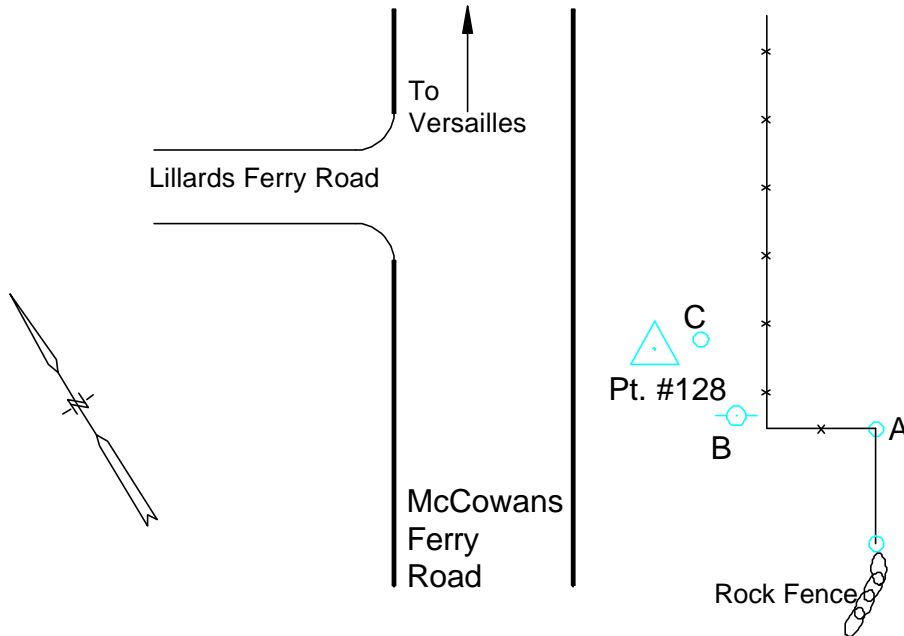



Photo Science, Inc.

CONTROL REFERENCE SUMMARY

Project Name: Woodford County GIS		Agency: VMWC Planning	
Quad Sheet: Salvisa	County: Woodford	State: KY	Date Set: 10/1/2004
Station: 128 AZ	Type of Mark: Concrete Monument	Stamping on Mark: 128 AZ	Established By: Photo Science, Inc.
Elev (USFeet) 846.98	Elev (M): 258.160	Datum: NAVD88	
Northing (USFeet) 172,811.42	Easting (USFeet) 1,489,578.75	Datum: KY North	
Northing (M) 52,673.026	Easting (M) 454,024.511	Datum: KY North	
Latitude: 37°58'24.13169"N	Longitude: 84°46'23.73414"W	Datum: NAD83	
Ahead Station: 128	Ahead Azimuth: 208 ° 06' 38 "	Ahead Distance: 495.15	
Back Station:	Back Azimuth: ° ' "	Back Distance:	
Data Entry: GB	Checked By: MEM	Date: 11/30/2004	

- A: 15.5' TO CENTER OF ROAD
- B: 44.0' TO "CURVE TO RIGHT" SIGN
- C: 4.2' TO A CARSONITE POST

Point #128 AZ

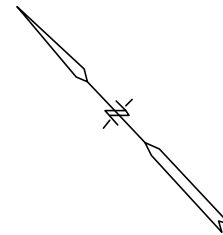
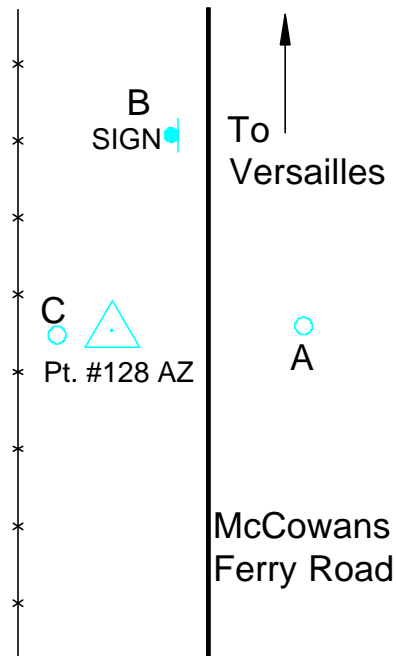



Photo Science, Inc.

CONTROL REFERENCE SUMMARY

Project Name: Woodford County GIS		Agency: VMWC Planning	
Quad Sheet: Salvisa	County: Woodford	State: KY	Date Set: 10/1/2004
Station: 129	Type of Mark: Concrete Monument	Stamping on Mark: 129	Established By: Photo Science, Inc.
Elev (USFeet) 869.92	Elev (M): 265.152	Datum: NAVD88	
Northing (USFeet) 163,866.34	Easting (USFeet) 1,482,943.03	Datum: KY North	
Northing (M) 49,946.560	Easting (M) 452,001.940	Datum: KY North	
Latitude: 37°56'55.32307"N	Longitude: 84°47'45.93985"W	Datum: NAD83	
Ahead Station:	Ahead Azimuth: ° ' "	Ahead Distance:	
Back Station: 129 AZ	Back Azimuth: 156 ° 27 ' 47 "	Back Distance: 882.48	
Data Entry: GB	Checked By: MEM	Date: 11/30/2004	

- A: 45.8' TO A TELEPHONE POLE
- B: 51.7' TO "STOP" SIGN
- C: 60.6' TO "NO OUTLET" SIGN

Point #129

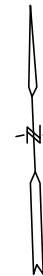
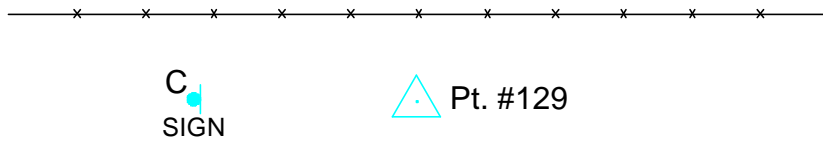

McCowans Ferry Road

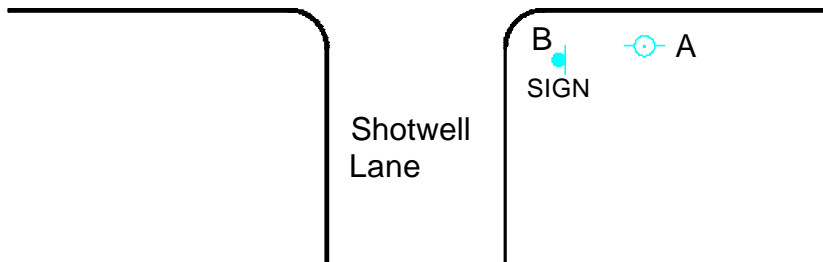

Shotwell Lane



Photo Science, Inc.

CONTROL REFERENCE SUMMARY

Project Name: Woodford County GIS		Agency: VMWC Planning	
Quad Sheet: Salvisa	County: Woodford	State: KY	Date Set: 10/1/2004
Station: 129 AZ	Type of Mark: Concrete Monument	Stamping on Mark: 129 AZ	Established By: Photo Science, Inc.
Elev (USFeet) 840.56	Elev (M): 256.203	Datum: NAVD88	
Northing (USFeet) 163,057.28	Easting (USFeet) 1,483,295.44	Datum: KY North	
Northing (M) 49,699.958	Easting (M) 452,109.354	Datum: KY North	
Latitude: 37°56'47.34571"N	Longitude: 84°47'41.48061"W	Datum: NAD83	
Ahead Station: 129	Ahead Azimuth: 336 ° 27' 47 "	Ahead Distance: 882.48	
Back Station:	Back Azimuth: ° ' "	Back Distance:	
Data Entry: GB	Checked By: MEM	Date: 11/30/2004	

- A: 14.0' TO MAILBOX @ 175 SHOTWELL
- B: 34.3' TO A 12" WALNUT TREE
- C: 33.7' TO A 14" PINE TREE

Point #129 AZ

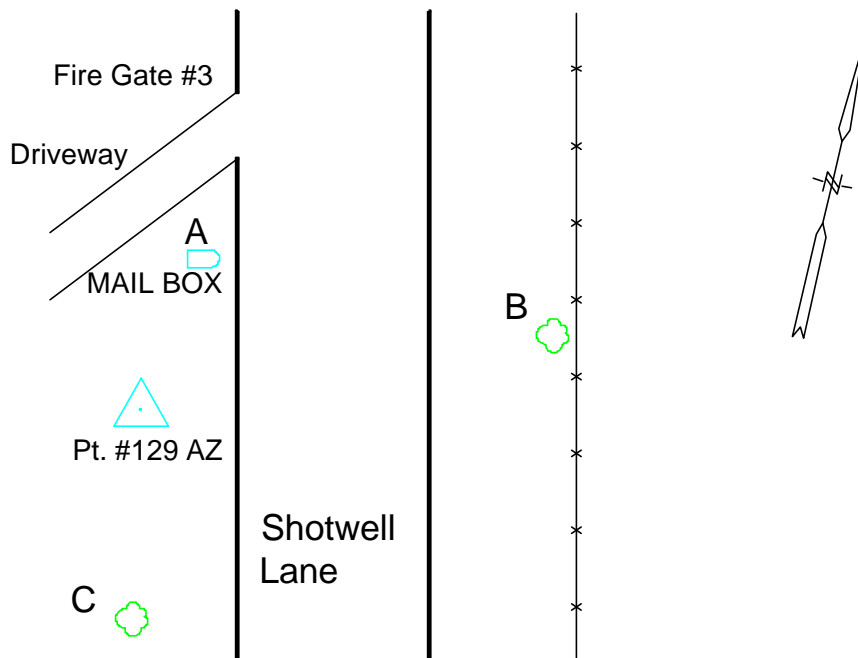



Photo Science, Inc.

CONTROL REFERENCE SUMMARY

Project Name: Woodford County GIS		Agency: VMWC Planning	
Quad Sheet: Salvisa	County: Woodford	State: KY	Date Set: 10/1/2004
Station: 130	Type of Mark: Concrete Monument	Stamping on Mark: 130	Established By: Photo Science, Inc.
Elev (USFeet) 865.28	Elev (M): 263.738	Datum: NAVD88	
Northing (USFeet) 164,195.70	Easting (USFeet) 1,485,493.35	Datum: KY North	
Northing (M) 50,046.949	Easting (M) 452,779.279	Datum: KY North	
Latitude: 37°56'58.72726"N	Longitude: 84°47'14.12578"W	Datum: NAD83	
Ahead Station:	Ahead Azimuth: ° ' "	Ahead Distance:	
Back Station: 130 AZ	Back Azimuth: 112 ° 46 ' 03 "	Back Distance: 752.88	
Data Entry: GB	Checked By: MEM	Date: 11/30/2004	

- A: 11.9' TO CENTER OF ELLISTON LANE
- B: 30.8' TO A 28" HACKBERRY TREE
- C: 26.8' TO FENCE CORNER

Point #130

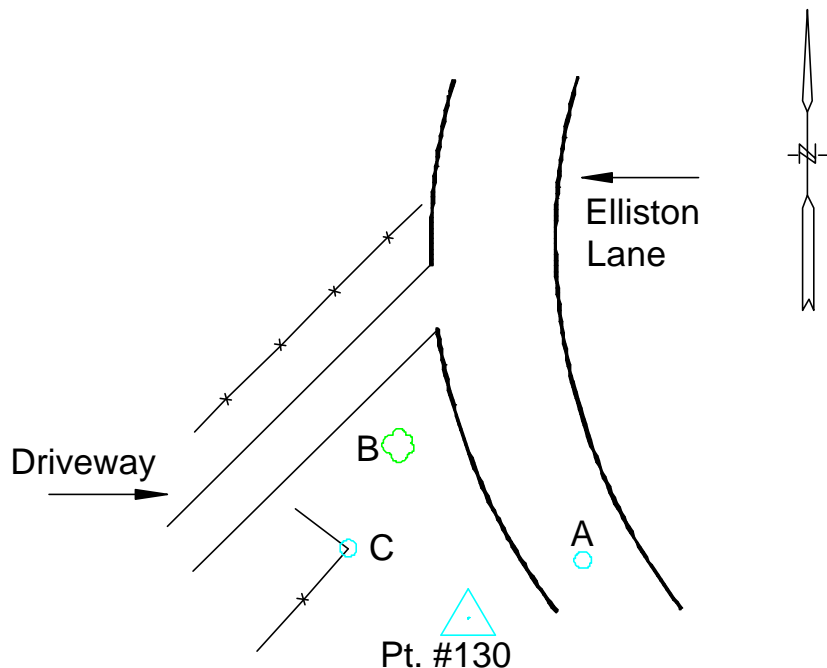



Photo Science, Inc.

CONTROL REFERENCE SUMMARY

Project Name: Woodford County GIS		Agency: VMWC Planning	
Quad Sheet: Salvisa	County: Woodford	State: KY	Date Set: 10/1/2004
Station: 130 AZ	Type of Mark: Concrete Monument	Stamping on Mark: 130 AZ	Established By: Photo Science, Inc.
Elev (USFeet) 862.43	Elev (M): 262.869	Datum: NAVD88	
Northing (USFeet) 163,904.34	Easting (USFeet) 1,486,187.57	Datum: KY North	
Northing (M) 49,958.143	Easting (M) 452,990.877	Datum: KY North	
Latitude: 37°56'55.88695"N	Longitude: 84°47'05.43790"W	Datum: NAD83	
Ahead Station: 130	Ahead Azimuth: 292 ° 46' 03 "	Ahead Distance: 752.88	
Back Station:	Back Azimuth: ° ' "	Back Distance:	
Data Entry: GB	Checked By: MEM	Date: 11/30/2004	

- A: 10.6' TO CENTER OF ELLISTON LANE
- B: 10.2' TO FENCE CORNER
- C: 84.1' TO A 18" ASH TREE

Point #130 AZ

